

**NOTES:**

- 0.5' CONTOURS DISPLAYED ON PLAN.
- UTILITY LOCATIONS SHOWN ON THE PLAN WERE PROVIDED BY THE UTILITY OWNER. FIELD LOCATIONS MAY VARY AND ADDITIONAL UTILITIES MAY EXIST.
- ALL PROPERTY LINES SHOWN ARE ESTABLISHED FROM OUTAGAMIE COUNTY GIS FILES. PROPERTY LINES MAY NOT REFLECT ACTUAL LOT LINE LOCATIONS AND ARE FOR INFORMATIONAL PURPOSES ONLY.
- PROPOSED PARKING SPACES SHALL BE DONE IN CONJUNCTION WITH THE ROAD URBANIZATION.

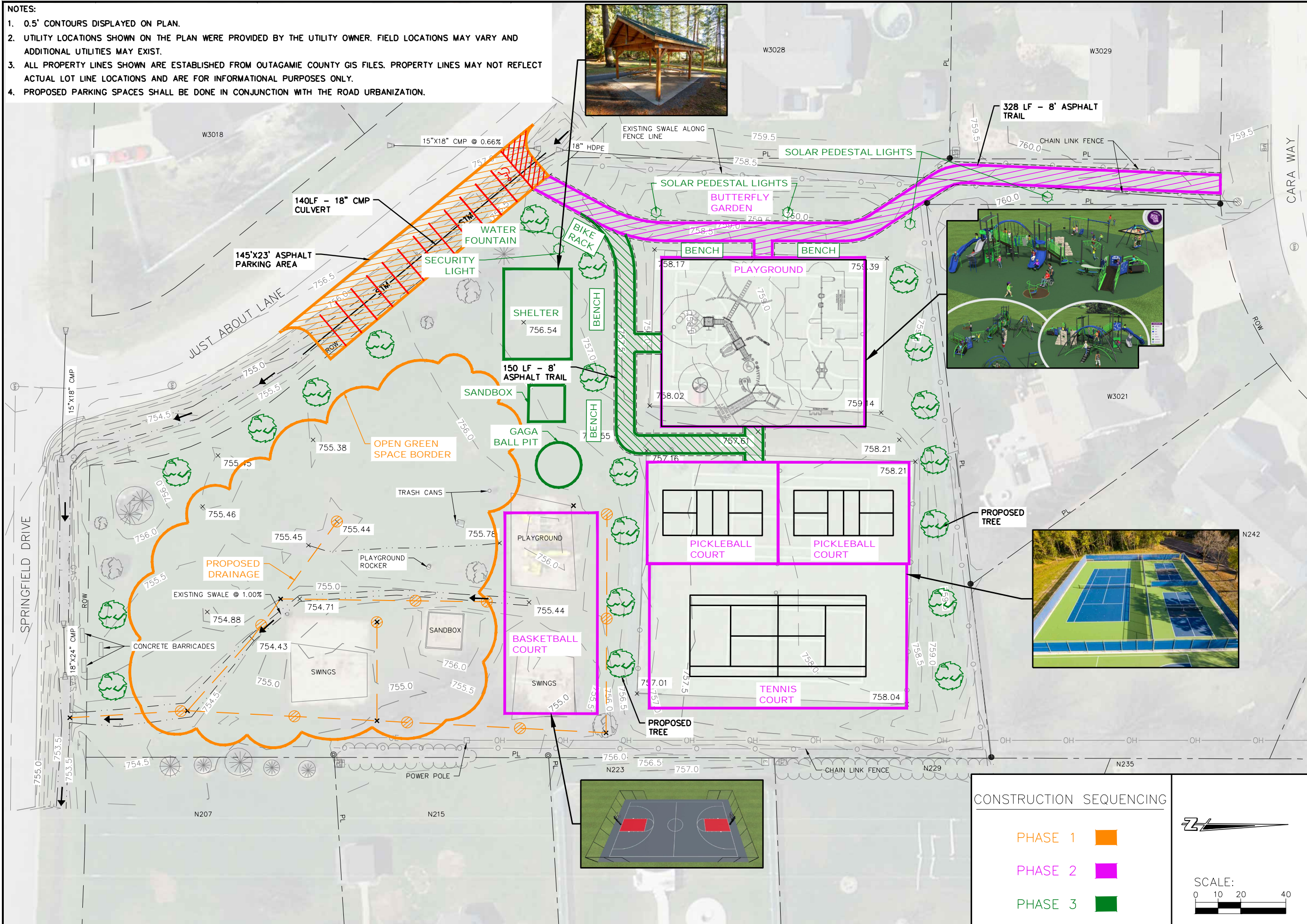

**CONSTRUCTION SEQUENCING**

- PHASE 1 ■
- PHASE 2 ■
- PHASE 3 ■

**SCALE:**

JOB NO.	4916-087
BOOK NO.	
DRAWN BY	JDB
CHECKED BY	JJK
DATE	7/13/2023
REVISIONS	
REFERENCE FILE	
DRAWING FILE	

**Cedar Corporation**

www.cedarcorp.com  
800-472-7572

engineers • architects • planners • environmental specialists  
land surveyors • landscape architects • interior designers

2850 Wilson Commons W.  
Suite 402  
Madison, WI 53718  
Cedarburg, WI 53012  
F2-204-2360  
FAX: 262-579-2668

1695 Bellevue Street  
Green Bay, WI 54311  
202-661-9080  
FAX: 920-255-2127

**TOWN OF BUCHANAN  
SPRINGFIELD PARK MASTER PLAN**

SHEET NO.	1 OF 1
-----------	--------

I:\Clients-CRBoy\B\B916 Buchanan Town of\130 Springfield Park Planning\04\_CADD\DWG\Springfield Drainage Study.dwg 07/13/23 2:26:01 PM