



5-12 YEARS

| | | | |
|--|----|----------|---|
| TOTAL ELEVATED PLAY COMPONENTS | 11 | | |
| TOTAL ELEVATED COMPONENTS ACCESSIBLE BY RAMP | 5 | REQUIRED | 5 |
| TOTAL ELEVATED COMPONENTS ACCESSIBLE BY TRANSFER | 6 | REQUIRED | 1 |
| TOTAL ACCESSIBLE GROUND LEVEL COMPONENTS SHOWN | 11 | REQUIRED | 4 |
| TOTAL DIFFERENT TYPES OF GROUND LEVEL COMPONENTS | 9 | REQUIRED | 9 |

2-5 YEARS

| | | | |
|--|---|----------|---|
| TOTAL ELEVATED PLAY COMPONENTS | 0 | | |
| TOTAL ELEVATED COMPONENTS ACCESSIBLE BY RAMP | 0 | REQUIRED | 0 |
| TOTAL ELEVATED COMPONENTS ACCESSIBLE BY TRANSFER | 0 | REQUIRED | 0 |
| TOTAL ACCESSIBLE GROUND LEVEL COMPONENTS SHOWN | 7 | REQUIRED | 0 |
| TOTAL DIFFERENT TYPES OF GROUND LEVEL COMPONENTS | 7 | REQUIRED | 7 |

SURFACING:
 TOTAL PIP = 5,950 SQ FT
 8' = 4,383 SQ FT
 4' = 1,567 SQ FT

landscape structures



The play components identified on this plan are IPEMA certified. (Unless model number is preceded with *) The use and layout of these components conform to the requirements of ASTM F1487. To verify product certification, visit www.ipema.org

THIS PLAY AREA & PLAY EQUIPMENT IS DESIGNED FOR AGES 5-12 YEARS UNLESS OTHERWISE NOTED ON PLAN.

IT IS THE MANUFACTURER'S OPINION THAT THIS PLAY AREA DOES CONFORM TO THE A.D.A. ACCESSIBILITY STANDARDS, ASSUMING AN ACCESSIBLE PROTECTIVE SURFACING IS PROVIDED, AS INDICATED, OR WITHIN THE ENTIRE USE ZONE.

THIS CONCEPTUAL PLAN WAS BASED ON INFORMATION AVAILABLE TO US. PRIOR TO CONSTRUCTION, DETAILED SITE INFORMATION INCLUDING SITE DIMENSIONS, TOPOGRAPHY, EXISTING UTILITIES, SOIL CONDITIONS, AND DRAINAGE SOLUTIONS SHOULD BE OBTAINED, EVALUATED, & UTILIZED IN THE FINAL DESIGN. PLEASE VERIFY ALL DIMENSIONS OF PLAY AREA, SIZE, ORIENTATION, AND LOCATION OF ALL EXISTING UTILITIES, EQUIPMENT, AND SITE FURNISHINGS PRIOR TO ORDERING. SLIDES SHOULD NOT FACE THE HOT AFTERNOON SUN.

CHOOSE A PROTECTIVE SURFACING MATERIAL THAT HAS A CRITICAL HEIGHT VALUE TO MEET THE MAXIMUM FALL HEIGHT FOR THE EQUIPMENT (REF. ASTM F1487 STANDARD CONSUMER SAFETY PERFORMANCE SPECIFICATION FOR PLAYGROUND EQUIPMENT FOR PUBLIC USE, SECTION B CURRENT REVISION). THE SUBSURFACE MUST BE WELL DRAINED IF THE SOIL DOES NOT DRAIN NATURALLY. IT MUST BE TILED OR SLOPED 1/8" TO 1/4" PER FOOT TO A STORM SEWER OR A "FRENCH DRAIN".

AREA OF ACCESSIBLE PROTECTIVE SURFACING (POURED-IN-PLACE SUGGESTED) 7,000 SQ FT

IT IS THE MANUFACTURER'S OPINION AND INTENT THAT THE LAYOUT OF THESE COMPONENTS CONFORM WITH THE U.S. CONSUMER PRODUCT SAFETY COMMISSION'S (CPSC) "HANDBOOK FOR PUBLIC PLAYGROUND SAFETY".

DESIGNED BY:
 KLP
 COPYRIGHT: 5/1/23
 LANDSCAPE STRUCTURES, INC.
 601 7th STREET SOUTH - P.O. BOX 198
 DELAWARE, MINNESOTA 55328
 PH: 1-800-328-9035 FAX: 1-763-972-6081

| | | |
|--------|--------------------|----------|
| 5/1/23 | 23050104-01 | KLP |
| Date | Previous Drawing # | Initials |



Springfield Park
 Buchanan, WI

Gerber Leisure Products, Inc.
 Doug Reimer

SYSTEM TYPE:
 Playbooster
 DRAWING #:
 23050104-02



landscape structures



The play components identified on this plan are IPEMA certified. (Unless model number is provided with ?) The use and layout of these components conform to the requirements of ASTM F1487. To verify product certification, visit www.ipema.org

THIS PLAY AREA & PLAY EQUIPMENT IS DESIGNED FOR AGES 5-12 YEARS UNLESS OTHERWISE NOTED ON PLAN.

IT IS THE MANUFACTURER'S OPINION THAT THIS PLAY AREA DOES CONFORM TO THE A.D.A. ACCESSIBILITY STANDARDS, ASSUMING AN ACCESSIBLE PROTECTIVE SURFACING IS PROVIDED, AS INDICATED, OR WITHIN THE ENTIRE USE ZONE.

THIS CONCEPTUAL PLAN WAS BASED ON INFORMATION AVAILABLE TO US PRIOR TO CONSTRUCTION. DETAILED SITE INFORMATION INCLUDING SITE DIMENSIONS, TOPOGRAPHY, EXISTING UTILITIES, SOIL CONDITIONS, AND DRAINAGE SOLUTIONS SHOULD BE OBTAINED, EVALUATED, & UTILIZED IN THE FINAL DESIGN. PLEASE VERIFY ALL DIMENSIONS OF PLAY AREA, SIZE, ORIENTATION, AND LOCATION OF ALL EXISTING UTILITIES, EQUIPMENT, AND SITE FURNISHINGS PRIOR TO ORDERING. SLICES SHOULD NOT FACE THE HOT AFTERNOON SUN.

CHOOSE A PROTECTIVE SURFACING MATERIAL THAT HAS A CRITICAL HEIGHT VALUE TO MEET THE MAXIMUM FALL HEIGHT FOR THE EQUIPMENT (REF. ASTM F1487 STANDARD CONSUMER SAFETY PERFORMANCE SPECIFICATION FOR PLAYGROUND EQUIPMENT FOR PUBLIC USE, SECTION 8 CURRENT REVISION). THE SUBSURFACE MUST BE WELL DRAINED. IF THE SOIL DOES NOT DRAIN NATURALLY IT MUST BE TILED OR SLOPED 1/8" TO 1/4" PER FOOT TO A STORM SEWER OR A "TRENCH DRAIN".

AREA OF ACCESSIBLE/PROTECTIVE SURFACING (POURED-IN-PLACE SUGGESTED) 7,000 SQ FT

IT IS THE MANUFACTURER'S OPINION AND INTENT THAT THE LAYOUT OF THESE COMPONENTS CONFORM WITH THE U.S. CONSUMER PRODUCT SAFETY COMMISSION'S (CPSC) "HANDBOOK FOR PUBLIC PLAYGROUND SAFETY".

DESIGNED BY: KLP

COPYRIGHT: 5/1/23 LANDSCAPE STRUCTURES, INC. 601 7th STREET SOUTH - P.O. BOX 198 DELAND, MINNESOTA 55328 PH: 1-800-338-0635 FAX: 1-763-972-6081

| | | |
|--------|--------------------|----------|
| 5/1/23 | 23050104-01 | KLP |
| Date | Previous Drawing # | Initials |

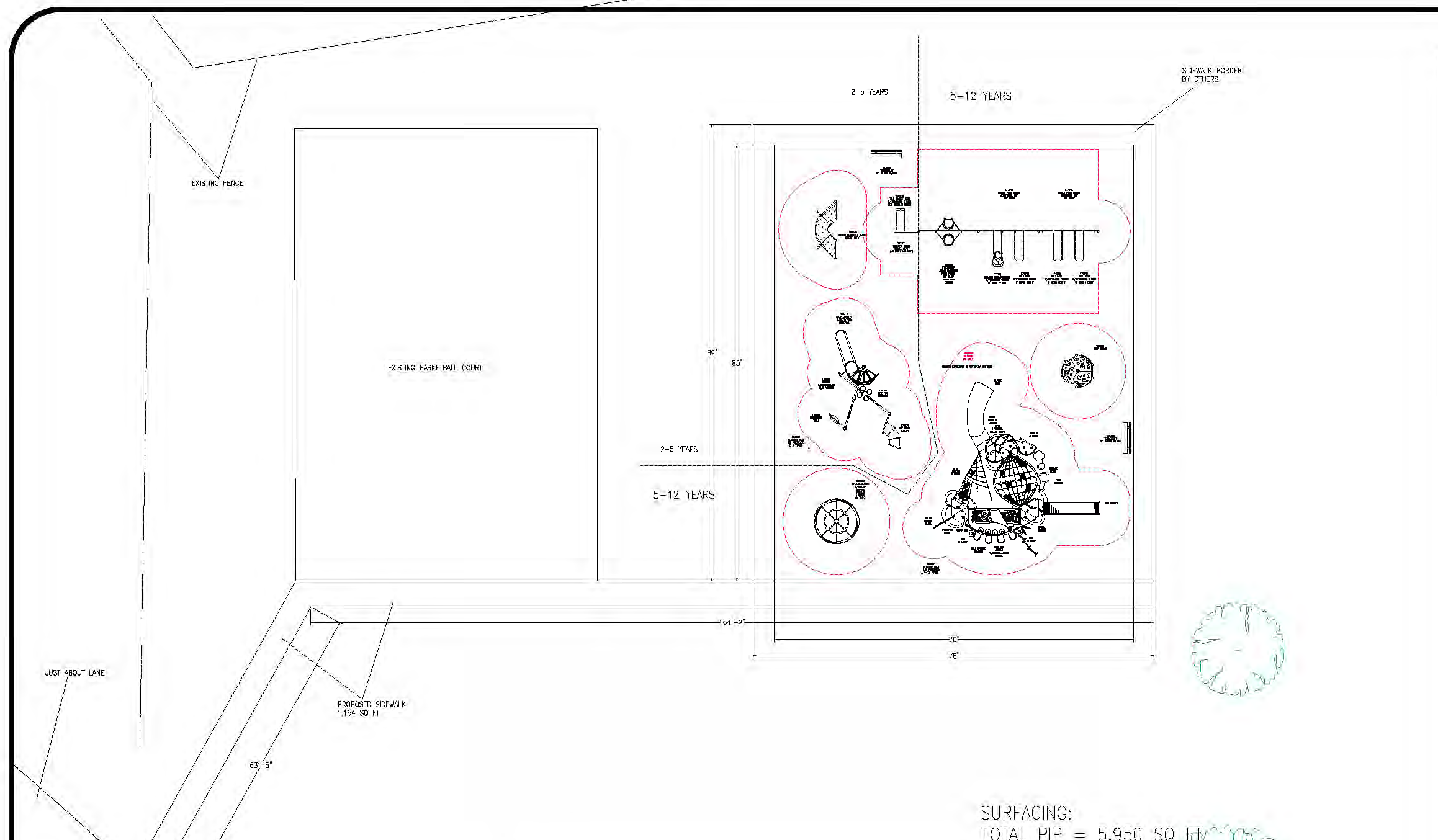

5-12 YEARS

| | | | |
|--|----|----------|---|
| TOTAL ELEVATED PLAY COMPONENTS | 11 | | |
| TOTAL ELEVATED COMPONENTS ACCESSIBLE BY RAMP | 5 | REQUIRED | 5 |
| TOTAL ELEVATED COMPONENTS ACCESSIBLE BY TRANSFER | 6 | REQUIRED | 1 |
| TOTAL ACCESSIBLE GROUND LEVEL COMPONENTS SHOWN | 11 | REQUIRED | 4 |
| TOTAL DIFFERENT TYPES OF GROUND LEVEL COMPONENTS | 9 | REQUIRED | 9 |

2-5 YEARS

| | | | |
|--|---|----------|---|
| TOTAL ELEVATED PLAY COMPONENTS | 0 | | |
| TOTAL ELEVATED COMPONENTS ACCESSIBLE BY RAMP | 0 | REQUIRED | 0 |
| TOTAL ELEVATED COMPONENTS ACCESSIBLE BY TRANSFER | 0 | REQUIRED | 0 |
| TOTAL ACCESSIBLE GROUND LEVEL COMPONENTS SHOWN | 7 | REQUIRED | 0 |
| TOTAL DIFFERENT TYPES OF GROUND LEVEL COMPONENTS | 7 | REQUIRED | 7 |

SURFACING:
TOTAL PIP = 5,950 SQ FT
8' = 4,383 SQ FT
4' = 1,567 SQ FT

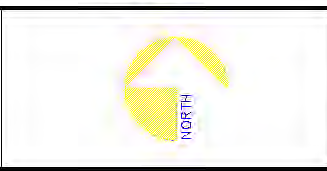
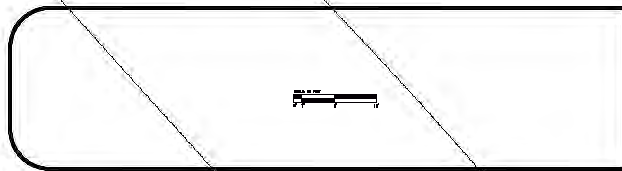

Springfield Park
Buchanan, WI

Gerber Leisure Products, Inc.
Doug Reimer

SYSTEM TYPE:
Playbooster
DRAWING #:
23050104-02





Springfield Park

Springfield Park • 2.6.2024



© 2024 Landscape Structures. All Rights Reserved



Springfield Park

Springfield Park • 2.6.2024



© 2024 Landscape Structures. All Rights Reserved



Springfield Park

Springfield Park • 2.6.2024



© 2024 Landscape Structures. All Rights Reserved



Springfield Park

Springfield Park • 2.6.2024



© 2024 Landscape Structures. All Rights Reserved



Springfield Park

Springfield Park • 2.6.2024



© 2024 Landscape Structures. All Rights Reserved



Springfield Park

Springfield Park • 2.6.2024



© 2024 Landscape Structures. All Rights Reserved



Springfield Park

Springfield Park • 2.6.2024



© 2024 Landscape Structures. All Rights Reserved



Springfield Park

Springfield Park • 2.6.2024



© 2024 Landscape Structures. All Rights Reserved