

Map 5-1 Town of Buchanan Comprehensive Plan Update Multi Modal

Legend

- S Valley Transit Shelters
- Valley Transit Stops
- Paved Off Road Shared Use Path
- Unpaved Off Road Shared Use Path
- - - Planned On Road & Off Road Facility
- - - Planned Off Road Facility
- - - Planned On Road Facility
- Valley Transit Routes

Source:
Base data provided by Outagamie County 2016.
Bicycle & Pedestrian data provided by
Outagamie County, Town of Buchanan, and ECWRPC 2015.

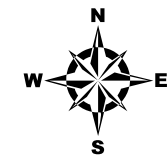

0 0.25 0.5 1
Scale in Miles

This data was created for use by the East Central Wisconsin Regional Planning Commission Geographic Information System. Any other use/application of this information is the responsibility of the user and such use/application is at their own risk. East Central Wisconsin Regional Planning Commission disclaims all liability regarding fitness of the information for any use other than for East Central Wisconsin Regional Planning Commission business.

PREPARED MAY 2017 BY:
East Central Wisconsin
Regional Planning Commission
ECWRPC

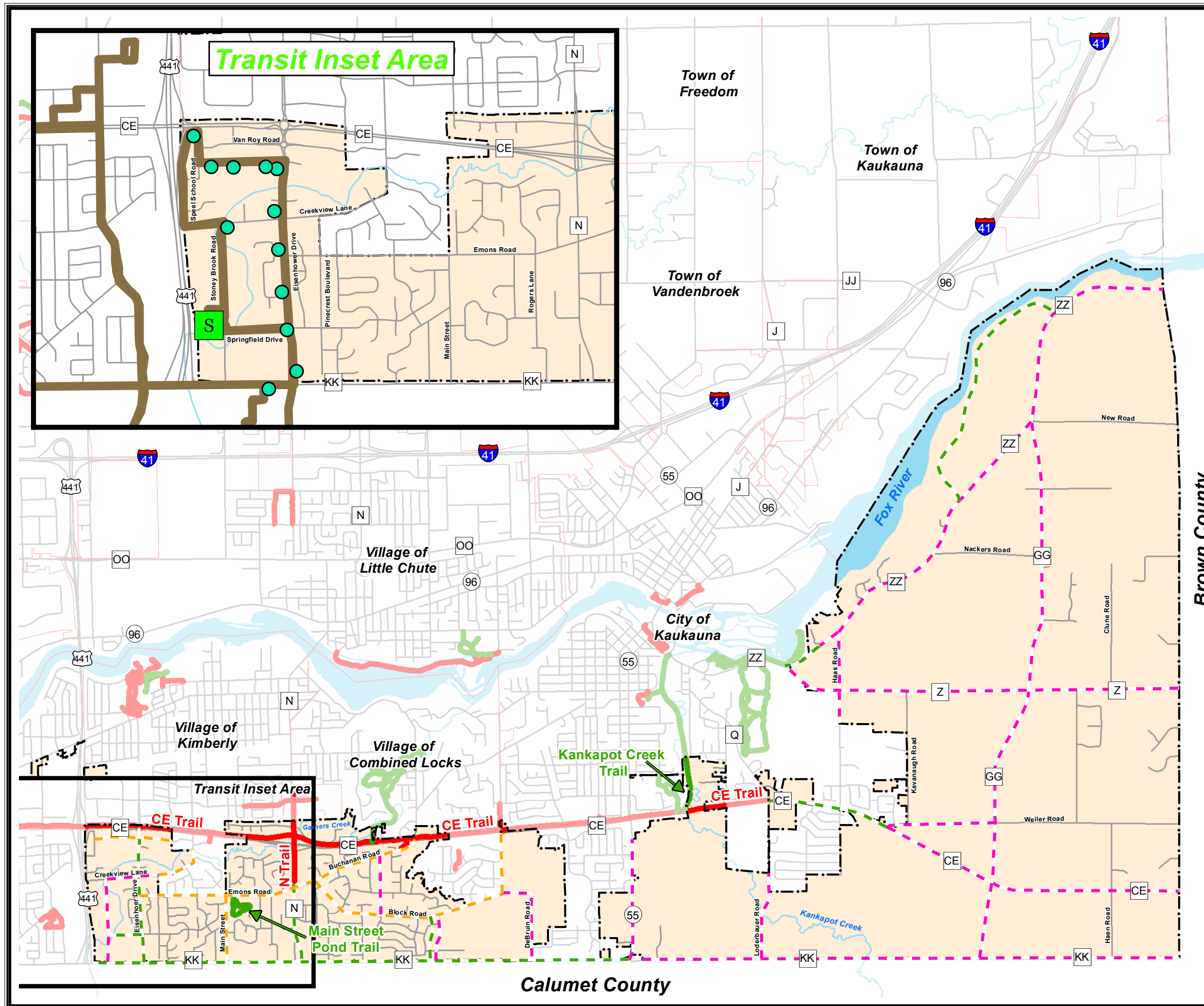









Brown County

Calumet County

Map 5-2 Town of Buchanan Comprehensive Plan Update Functional Classification

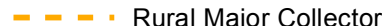
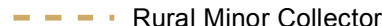
Legend

-  ZZ Vacated, Rerouted to Haas Road
-  Urban Principal Arterial
-  Urban Minor Arterial
-  Urban Collector
-  Rural Principal Arterial
-  Rural Minor Arterial
-  Rural Major Collector
-  Rural Minor Collector
-  Local Road
-  Planned Roads

Source:
Base data provided by Outagamie County 2016.
Functional Classification data provided by WIS DOT 2016.

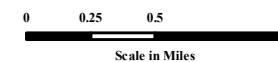
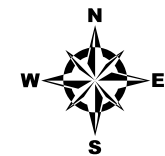

This data was created for use by the East Central Wisconsin Regional Planning Commission Geographic Information System. Any other use/application of this information is the responsibility of the user and such use/application is at their own risk. East Central Wisconsin Regional Planning Commission disclaims all liability regarding fitness of the information for any use other than for East Central Wisconsin Regional Planning Commission business.

PREPARED MAY 2017 BY:

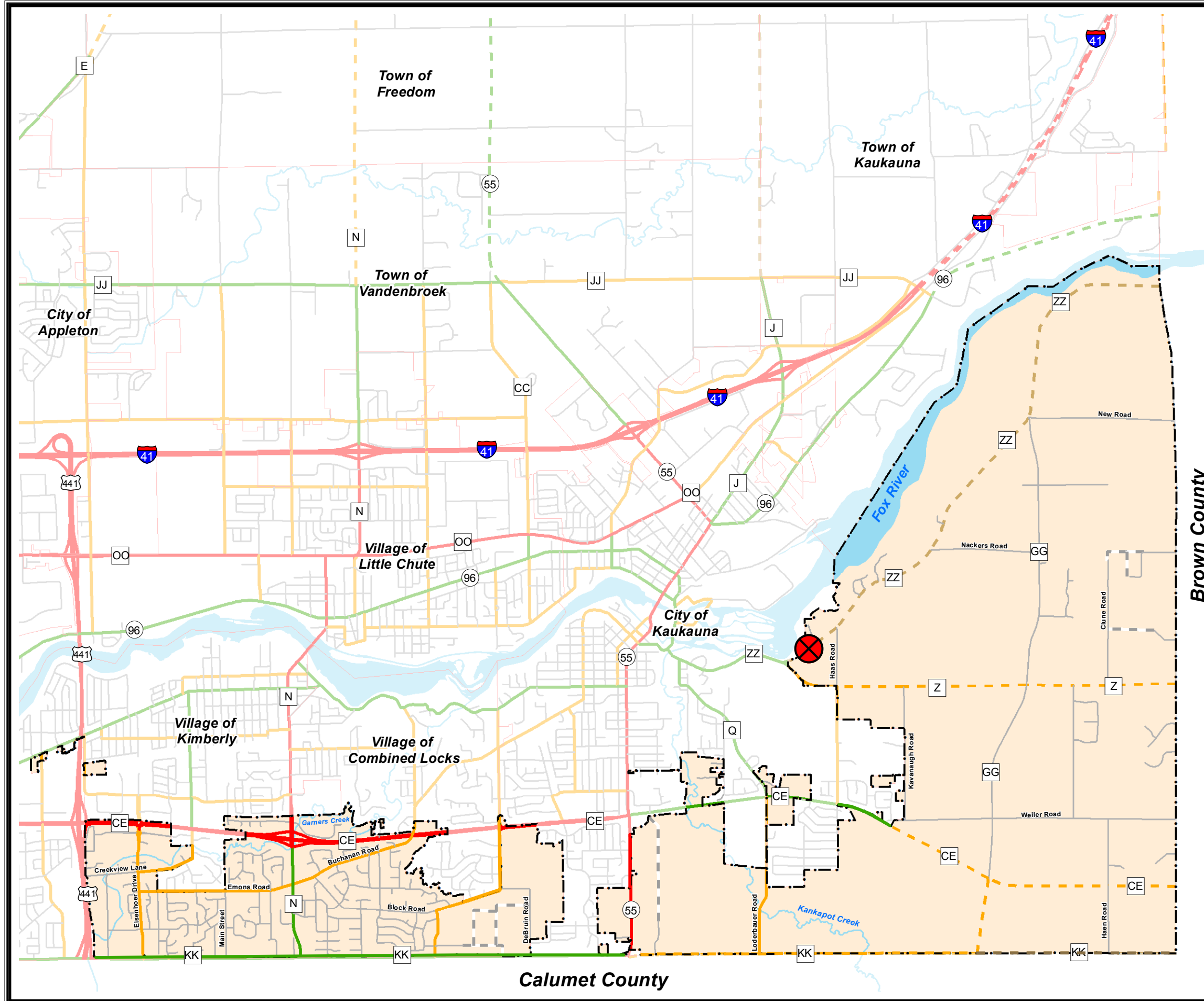

Map 5-3 Town of Buchanan Comprehensive Plan Update Average Annual Daily Traffic, Freight & Trucking Terminals, & Bridge Sufficiency Ratings

Legend

- AADT **2016**
- AADT **2010**
- Bridge Replacement Funding Eligible
- Bridge Rehabilitation Funding Eligible
- Sufficient Bridge
- No Trucking Limit
- 75 Foot Trailer Limit
- 65 Foot Trailer Limit
- Freight Terminals

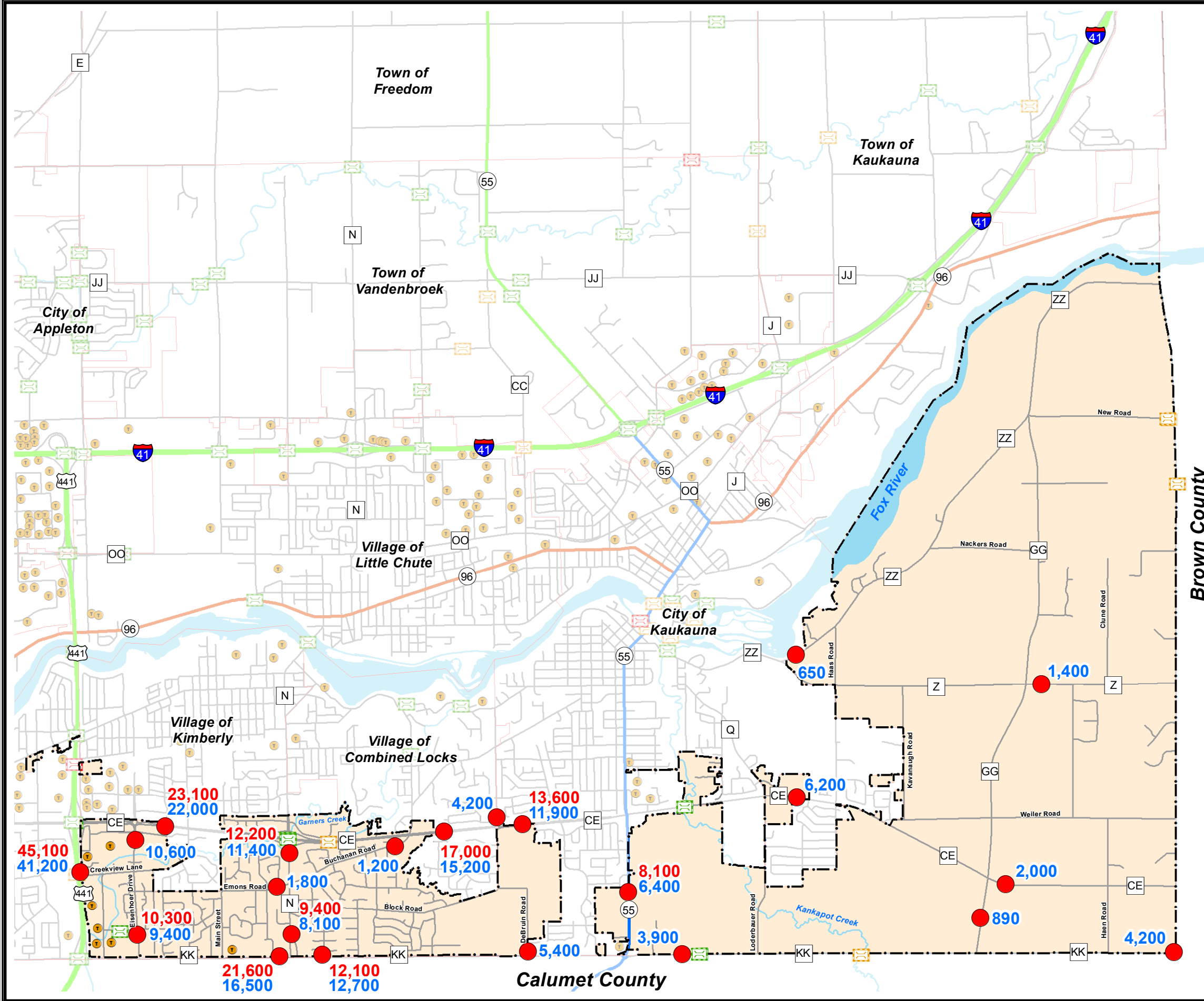

Source:
Base data provided by Outagamie County 2016.
AADT data provided by WIS DOT 2016.
Bridge data provided by WIS DOT 2014.
Freight data provided by WIS DOT 2015.
Freight Terminals provided by ECWRPC 2015.

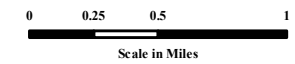

This data was created for use by the East Central Wisconsin Regional Planning Commission Geographic Information System. Any other use/application of this information is the responsibility of the user and such use/application is at their own risk. East Central Wisconsin Regional Planning Commission disclaims all liability regarding fitness of the information for any use other than for East Central Wisconsin Regional Planning Commission business.

PREPARED MAY 2017 BY:
East Central Wisconsin
Regional Planning Commission
ECWRPC

Map 5-4 Town of Buchanan Comprehensive Plan Update PASER Ratings 2015

Legend

- Excellent to Very Good
- Good to Fair
- Fair to Failed
- Not Rated

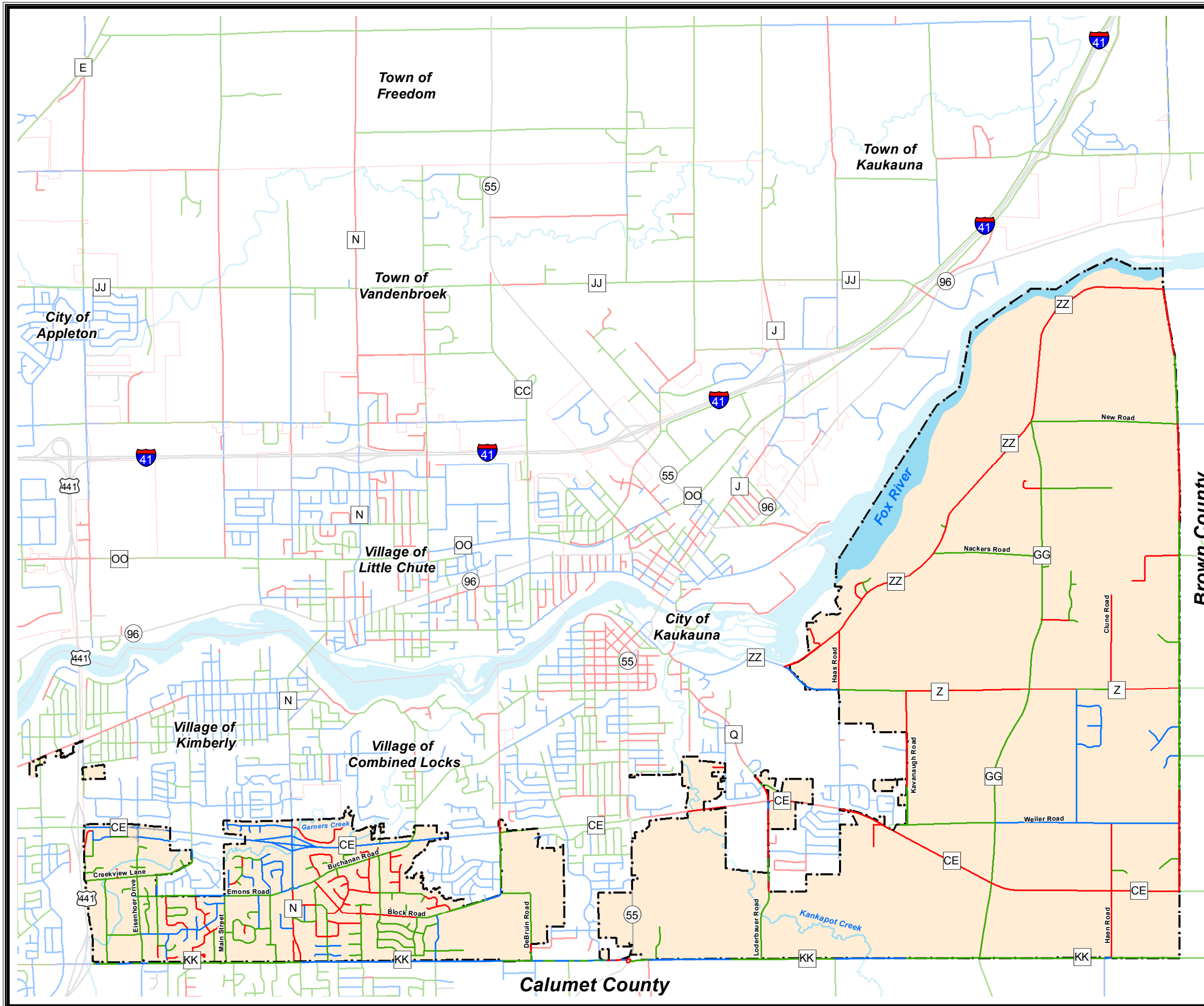

Source:
Base data provided by Outagamie County 2016.
PASER data provided by WIS DOT 2016.

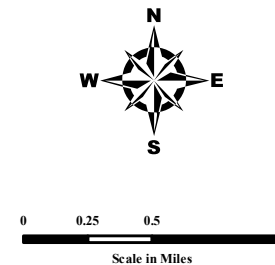

This data was created for use by the East Central Wisconsin Regional Planning Commission Geographic Information System. Any other use/application of this information is the responsibility of the user and such use/application is at their own risk. East Central Wisconsin Regional Planning Commission disclaims all liability regarding fitness of the information for any use other than for East Central Wisconsin Regional Planning Commission business.

PREPARED MAY 2017 BY:

